

Levee FineWire series is a cost-effective, highly resilient, and electrically conductive knitted metal mesh solution designed to provide reliable EMI shielding, EMP protection, and effective electrical grounding at joints and seams of various enclosure structures.

Formed by precisely weaving metal wires into a uniform grid structure, offers excellent mechanical strength, durability, and outstanding functional adaptability, making it suitable for demanding industrial and electronic applications.

To reduce production cost and lead time, available in a wide range of standard cross-sectional sizes and configurations, enabling flexible integration into different design requirements while maintaining consistent performance.

Double round wire mesh (Tin-plated copper-clad steel)

Type	Overall dimension (mm)	Diameter
LVDRM32G	25.4	∅ 3.2
LVDRM48G	25.4	∅ 4.8
LVDRM64G	25.4	∅ 6.4

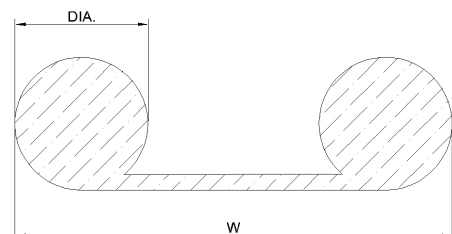

Wire diameter (mm): 0.12 ± 0.01

Tensile strength (kgf/mm²): ≥ 65

Elongation (%): ≥ 10