

Levee EMI shielding fingerstrip is specifically designed for use in shielded doors of wide range of shielding environments, ensures continuous electrical conductivity, effectively preventing electromagnetic leakage.

Manufactured from high-quality material, features excellent elasticity, durability, maintains stable contact pressure over long-term operation, even under frequent opening and closing cycles.

Various profiles are available to accommodate different door structures and installation requirements. Provide original colors and nickel plating

77-0350

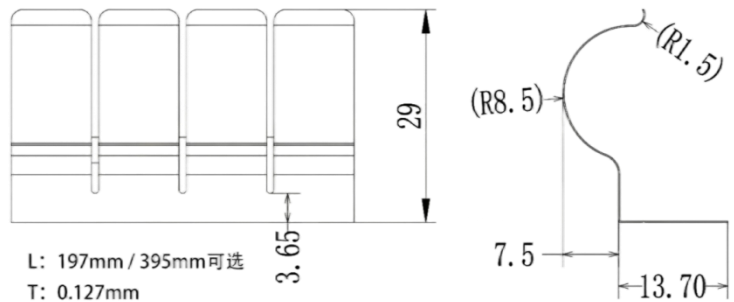

77-0400

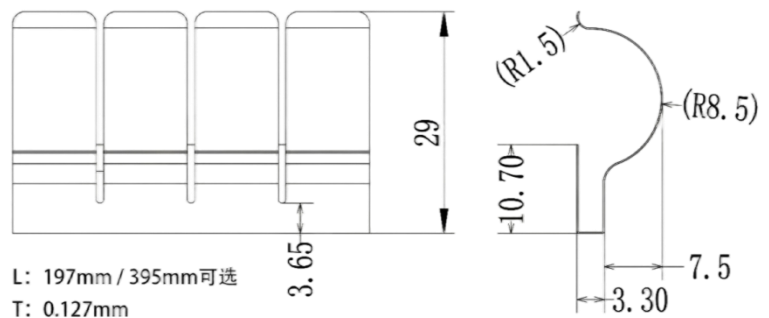

97-0350

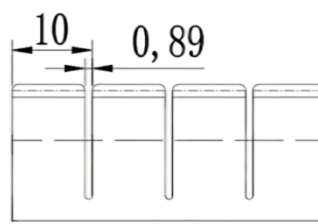

L: $199.4 \pm 0.5\text{mm}$
T: 0.10mm

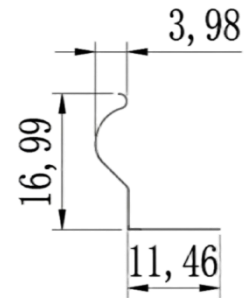

97-0400

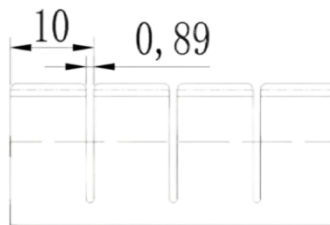

L: $199.4 \pm 0.5\text{mm}$
T: 0.10mm

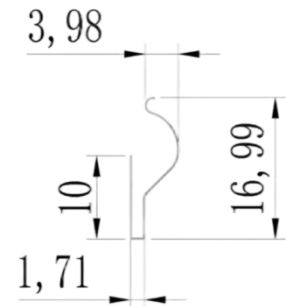

97-1780

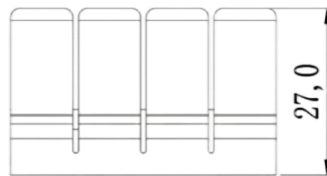

L: 200mm / 400mm 可选
T: 0.18mm

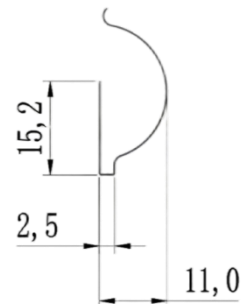

97-3960

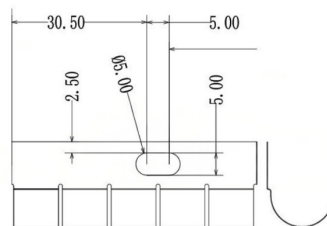

L: $199.4 \pm 0.5\text{mm}$
T: 0.10mm

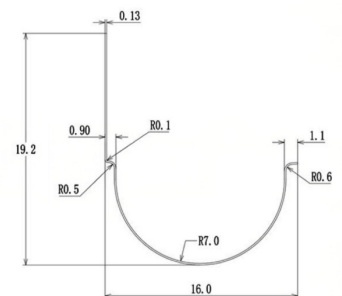

97-4380



L: 609 ± 1mm (64个PIN脚)

T: 0.127mm

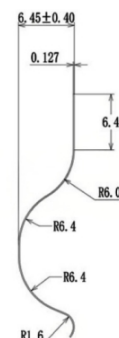
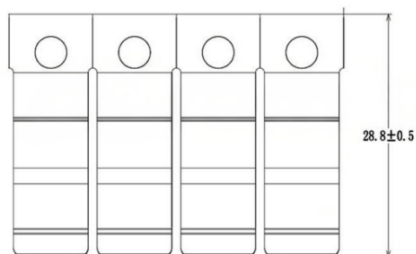

97-4400



L: 609.5 ± 1mm (48个PIN脚)

T: 0.18mm

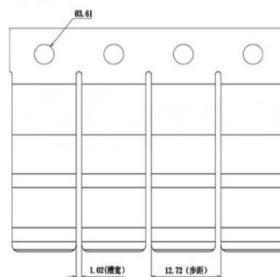

97-5350



L: 609 ± 1mm (64个PIN脚)

T: 0.13mm

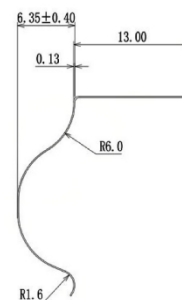

97-6400

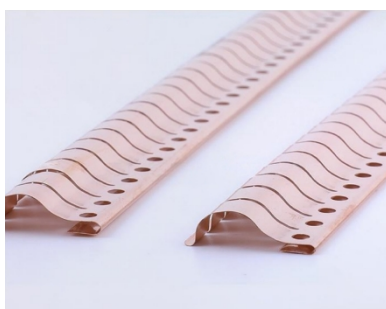

L: 408.6 ± 1mm (43个PIN脚)

T: 0.127mm

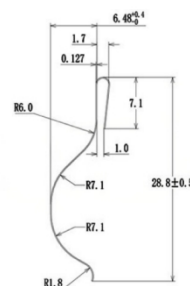
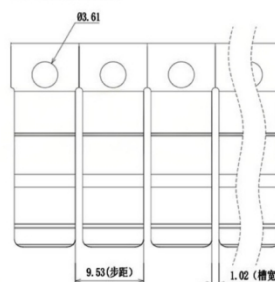

77-078L



L: 609 ± 1mm (39个PIN脚)
T: 0.1mm

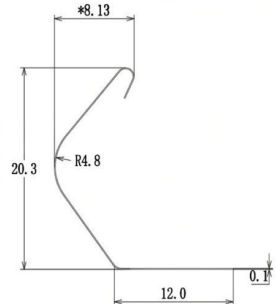
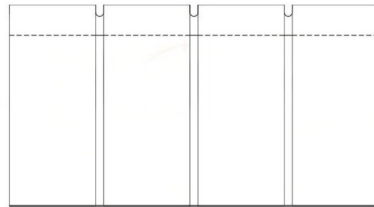

97-5050



L: 199.4 ± 0.5mm
T: 0.10mm

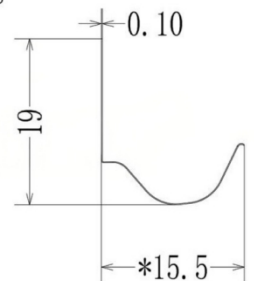
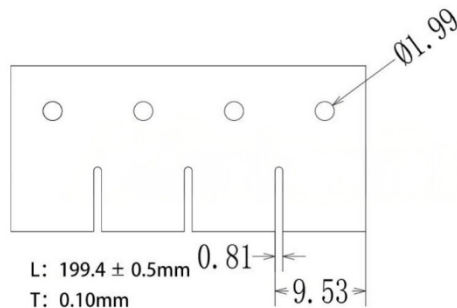

97-5250



L: 406mm
T: 0.08mm

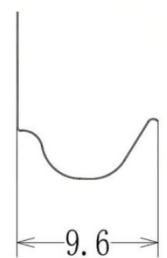
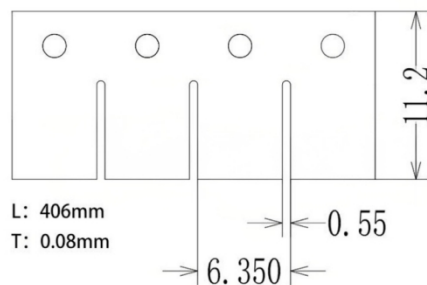

97-8500



L: 457mm (48个PIN脚)
T: 0.08mm

